



WhiteStar Legal Mapper

Trimble Denver User Conference

Mike Schiewe, Vice President of Operations

May 2, 2018

WLM drives better business decisions

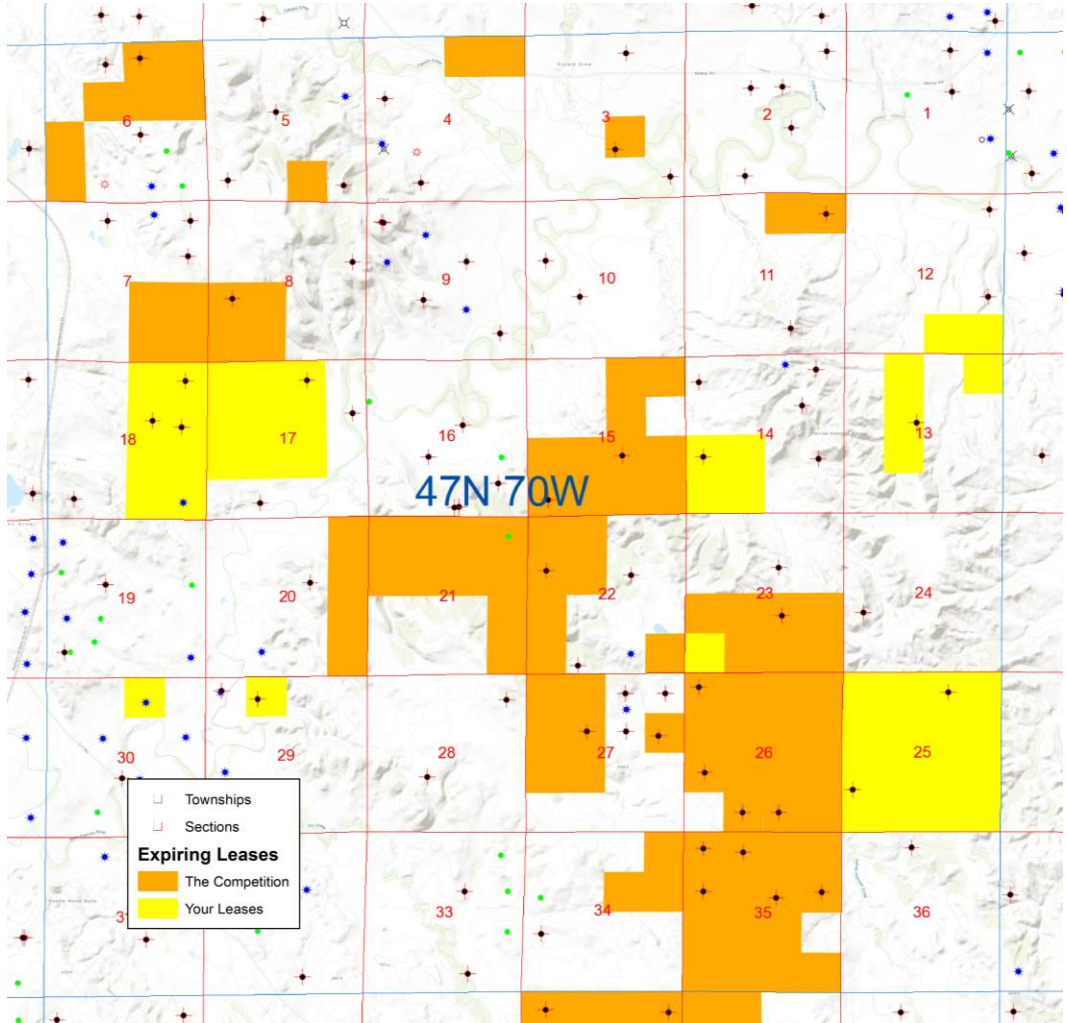

WhiteStar Wizard

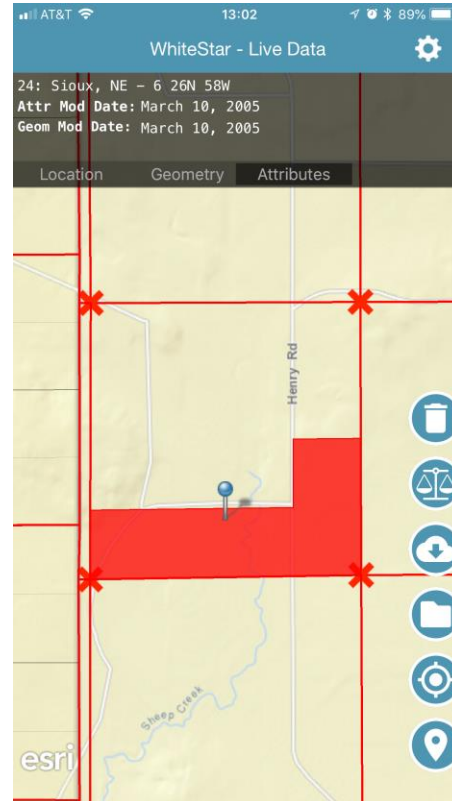
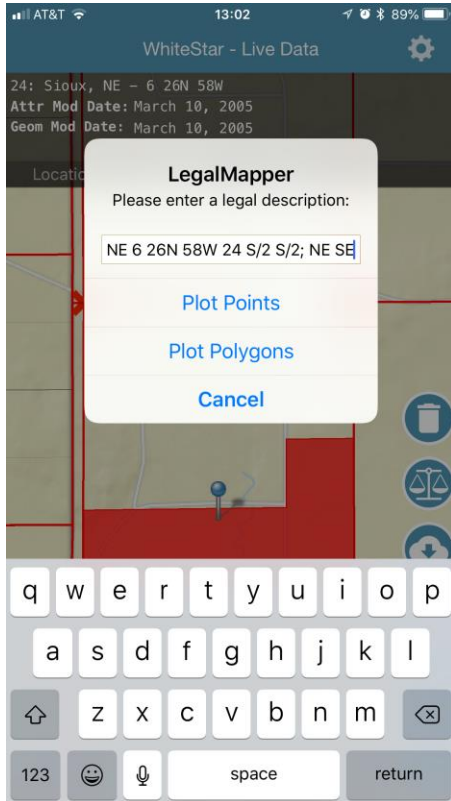

Mapping Individual Descriptions



WHITESTAR CLOUD [ClipZipShip](#) [WellSpotter](#) [LeaseBuilder](#) [Profile](#)

LEASEBUILDER

LeaseBuilder creates polygon geometry based on legal land descriptions (LLDs), within the United States on the Public Land Survey. The results can be downloaded in a variety of formats. To input an LLD, specify the state abbreviation (optional) and [USGS meridian code](#), followed by the township, range, section, half/half, quarter/quarter, lot and/or tract calls.

[Help with the input format](#)

UPLOAD FILE +

DATA ENTRY X

Enter land descriptions to locate by latitude and longitude.

- 1 WY 6 53N 69W 15 LOT 5 X
- 2 WY 6 53N 69W 15 NW NW X
- 3 WY 6 53N 69W 15 SE LESS NW SE X
- 4 WY 6 53N 69W 15 S2 S2 : N/2 SW X

+ ADD A LINE

Reset Locate

Transaction ID 6765
Status Ready for download
Requested a few seconds ago
Fulfilled a few seconds ago

[Download](#)

Status	Seq	Legal Land Description	
	1	WY 6 53N 69W 15 LOT 5	View on Map
	2	WY 6 53N 69W 15 NW NW	View on Map
	3	WY 6 53N 69W 15 SE LESS NW SE	View on Map
	4	WY 6 53N 69W 15 S2 S2 : N/2 SW	View on Map

Mapping Files of Descriptions



1	Identifier, Legal Description
2	1, WY 6 53N 69W 15 LOT 5
3	2, WY 6 53N 69W 15 NW NW
4	3, WY 6 53N 69W 15 SE LESS NW SE
5	4, WY 6 53N 69W 15 S2 S2 ; N/2 SW

WHITESTAR CLOUD ClipZipShip WellSpotter LeaseBuilder

LEASEBUILDER

LeaseBuilder creates polygon geometry based on legal land descriptions (LLDs), within the United States on the Public Land Survey. The results can be downloaded in a variety of formats. To input an LLD, specify the state abbreviation (optional) and USGS meridian code, followed by the township, range, section, half/half, quarter/quarter, lot and/or tract calls.

[Help with the input format](#)

UPLOAD FILE

Upload a CSV file with a column containing land descriptions to locate by latitude and longitude.

Step 1:

CHOOSE A FILE

WLM_demo.csv

Step 2:

WHICH COLUMN CONTAINS THE LEGAL LAND DESCRIPTIONS?

Step 3 (optional):

WHICH COLUMN CONTAINS THE IDENTIFIER FOR YOUR LAND DESCRIPTIONS?

Save & Process

Return to List

Transaction ID: 6766
Status: Ready for download
Requested: a few seconds ago
Fulfilled: a few seconds ago

Download

Status	Seq	Legal Land Description	
	1	WY 6 53N 69W 15 LOT 5	View on Map
	2	WY 6 53N 69W 15 NW NW	View on Map
	3	WY 6 53N 69W 15 SE LESS NW SE	View on Map
	4	WY 6 53N 69W 15 S2 S2 ; N/2 SW	View on Map

Process Legal Descriptions in FME



1	Identifier, Legal Description
2	1,WY 6 53N 69W 15 LOT 5
3	2,WY 6 53N 69W 15 NW NW
4	3,WY 6 53N 69W 15 SE LESS NW SE
5	4,WY 6 53N 69W 15 S2 S2 ; N/2 SW

The screenshot shows the FME Desktop interface. The top window displays a workflow with three main components: a CSV reader, a WhiteStar Mapper, and a WhiteStar Output writer. The CSV reader is configured with columns for 'Identifier' and 'Legal Description'. The WhiteStar Mapper has an 'Input' port connected to the CSV reader, an 'Output' port, and a '<Rejected>' port. The WhiteStar Output writer is connected to the 'Output' port of the mapper. Below the workflow is a map view showing a topographic map with several rectangular parcels outlined in brown. The map includes labels for 'Deep Creek' and 'Spring'. At the bottom of the map view, there is a small text attribution: "© 2008 ESRI, DELOITTE, UGS, FAO, NPS, NRCAN, GeBCO, IGN, Karlsruhe, Ordnance Survey, Esri Japan, METI, Esri China (Hong Kong), swisstopo, Mapbox India, © OpenStreetMap contributors".

Drag – Drop – Map Legals Inside ArcGIS Pro



- Demonstration

InDeed

- WhiteStar Cloud Metes and Bounds Application



Metes and Bounds Segments



- Point of beginning (commencement)
- Run
 - Bearing and distance
- Curve
 - Multiple curve types
- Meander
 - Following a river or natural feature

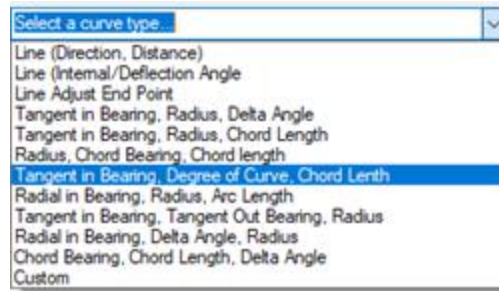

Workflow

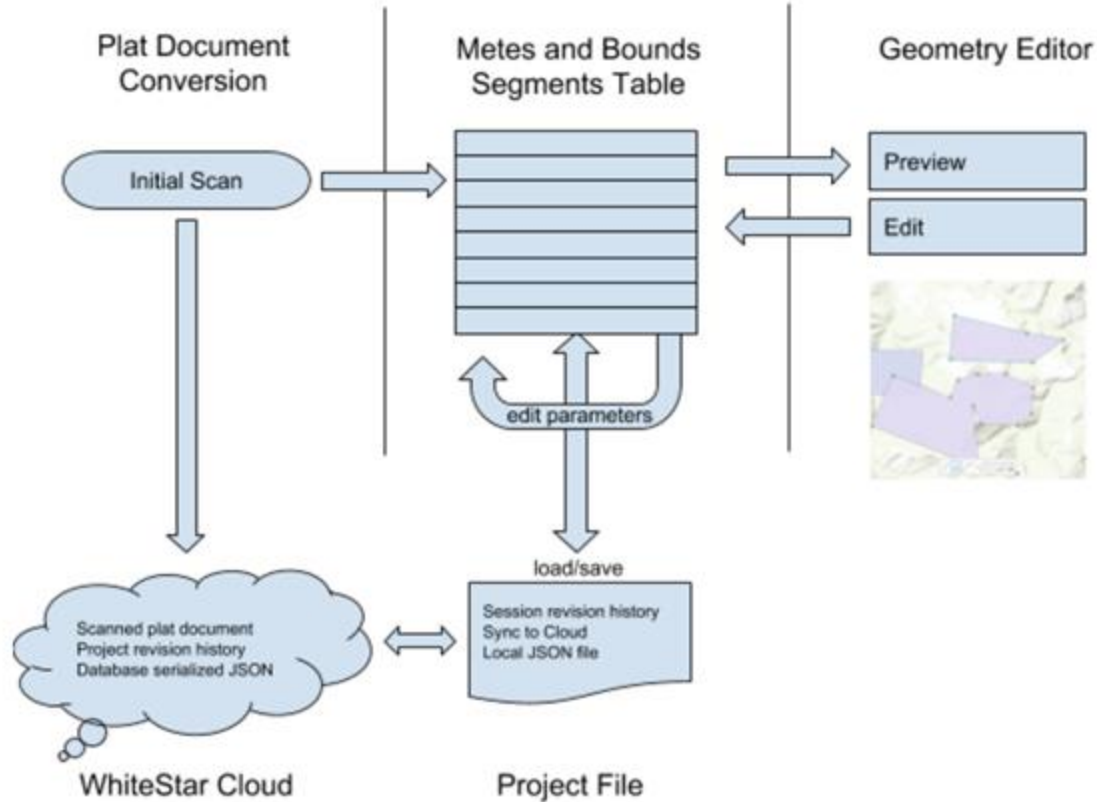

ArcGIS Pro Integration



ArcGIS Pro Module AddIn (.NET SDK) integrates:

- WhiteStar Cloud OCR Services
- InDeed Segment Editor for constructing plats
- InDeed Cloud Services for project control

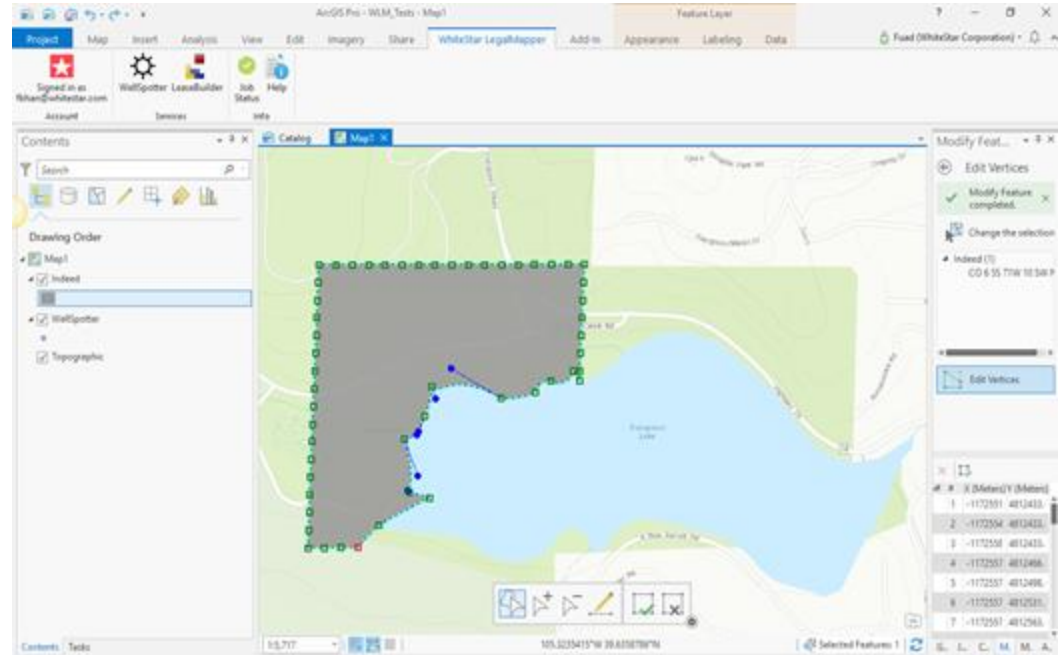

Questions?



For more information or to sign up for a free trial visit:

www.whitestar.com